

Replacement Guide for Legends Pinball Leg Set

► Package includes:

(Compatible with Legends Pinball Micro)

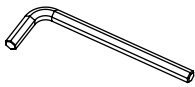

Hex key

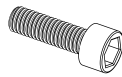

Screws (2 per leg, 2 spare)



Leg X4

► For Legends Pinball:

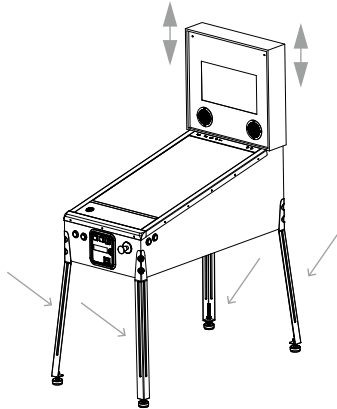

Step 1. Separate the Backbox, and remove the legs from the main cabinet.

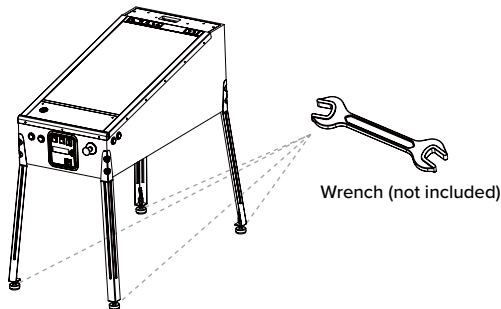

Step 3. Position the playfield upright. Use the wrench to adjust the height of the playfield to your liking. Tighten the base screws when set.

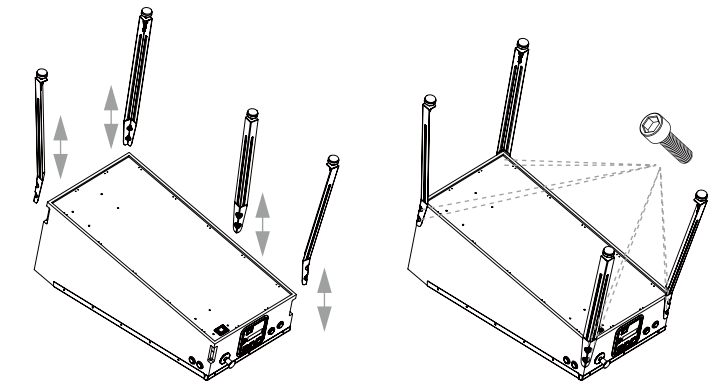

Step 2. Take out legs, and 8 screws. Put the main cabinet upside down on a soft surface. Attach the legs to the main cabinet and insert 8 screws to the matching holes with hex key.

Warning:

- You might need a second person to help due to the weight of the machine. Please exercise extra caution when moving the cabinet body and backbox.
- Please note that when assembling the machine, the top rear of the playfield cabinet has an opening for connecting the backbox.
- Because of the weight of the cabinet body, carrying the cabinet body by grabbing onto the opening can cause serious damage to both the body and electronics inside.

Note: The color of screws may fade in normal wear and tear in a period of time.

► For Legends Pinball Micro:

Step 1. Separate the Backbox, and remove the leg brackets from the main cabinet. (To remove the leg bracket, please remove the rubber foot and the screws under it with the Phillips-head screwdriver included in the Legends Pinball Micro's package.)

Next, please follow the same process of Step 2 and Step 3 above to complete the assembly of the leg set for Legends Pinball Micro.

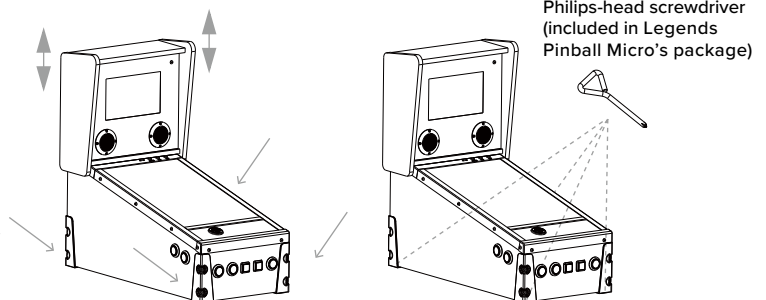

AtGames

© 2022 AtGames Interactive
www.atgames.net
PO Box 1691, El Segundo, CA 90245
All rights reserved.

*Content and images are for reference only and subject to change.

The trademarks and images are the properties of their respective owners. © 2022 AtGames

Made in China



www.atgames.us



www.atgames.net/arcades/contact/

Please find the most updated product info at www.atgames.us.
For customer service, warranty info, and technical support please find us here:
<https://www.atgames.net/arcades/contact/>