



ATARI FLASHBACK® PORTABLE

Instruction Manual

MODEL NO.: AP3280B

IMPORTANT: READ BEFORE USE

In very rare circumstances, some people may experience epileptic seizures when viewing flashing lights or patterns in our everyday life. Flashing lights and patterns are also common to almost any video game. Please consult your physician before playing ANY video game if you have had an epileptic condition or seizure OR if you experience any of the following while playing - Altered vision, eye or muscle twitching, mental confusion or disorientation, loss of awareness of the surroundings or involuntary movements. It is advised to take a 20-minute rest after 1 hour of continuous play.

Atari Flashback® Portable

Appearance and Key List

The image below shows the location of the connectors and buttons. Each function is outlined below the image.

- | | |
|----------------|------------------------------|
| 1 AV Out | 10 P Key |
| 2 Replay | 11 S Key |
| 3 Menu | 12 L Key |
| 4 Earphones | 13 R Key |
| 5 Micro USB | 14 T Key |
| 6 SD Card Slot | 15 A Key |
| 7 Save | 16 Power Switch |
| 8 Volume | 17 Rechargeable Battery Pack |
| 9 Start | |

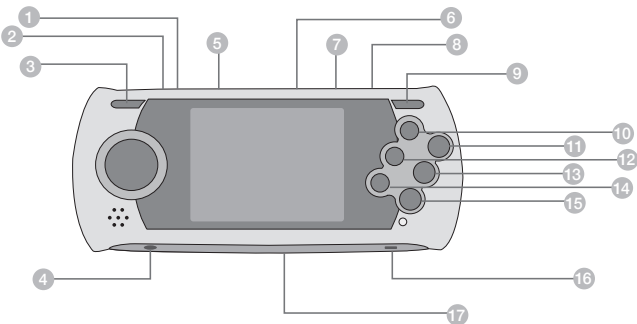

POWER SUPPLY

Please prepare one of the following and connect it to the included USB cable:

- Any certified USB AC Adaptor (sold separately)
- USB ports on PC (Standard-A)

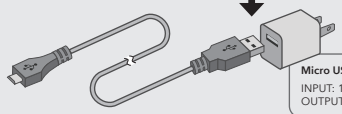

Micro USB Specification
INPUT: 100V-240V AC
OUTPUT: 5V/500mA

NOTE

- The handheld may not operate properly depending on the USB device.
- While some USB-compatible devices may be able to supply power to the handheld, AtGames cannot recommend any particular device. Please make sure to follow the instructions of any third-party device.

Your battery should be fully charged after 11 hours for the first time, and subsequent charging will take about 3 hours each time. After each full charge, the battery can provide you about 2 hours of game playing.

CONNECTING TV

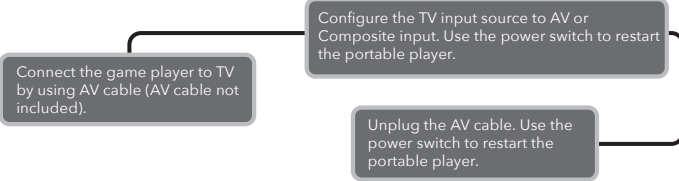

NOTE: Display results will vary by TV. Consult your TV's manual to adjust Brightness, Sharpness, Contrast, Aspect Ratio, and other features for best display results.

Input Instruction

If your TV does not have a dedicated composite input, it may support such a connection through a shared component input. For TVs with shared component inputs, the diagram below indicates a typical setup, with the yellow composite video connector plugging into the green component video input. Refer to your TV's manual for additional information on available ports and how to change inputs once connected.

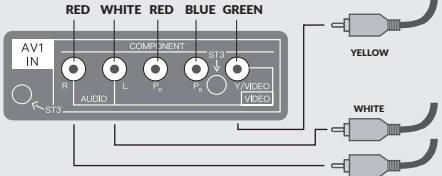

What can I do if my TV can only support HDMI input?

Check out AtGames Flashback Zone for products that support HDMI. <http://atgames.us>

Using SD Card

How to upgrade the handheld via SD card?

- Insert SD card to PC.
- Place "firmware.bin" in the folder.
- Power off the device and insert the SD card into the SD slot.
- Power on the device.
- The device will detect and load the firmware from SD card.

NOTE: 1. It is recommended to get the upgrade firmware directly from AtGames Flashback Zone or AtGames Support.
2. Some SD cards might not be compatible due to SD card conditions.
3. If the SD card is removed from the device, it will not load the firmware properly. The device will boot with the firmware installed in the flash memory instead.

How do I start playing?

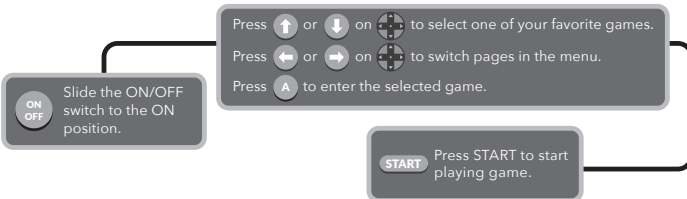

How do I rewind the game?

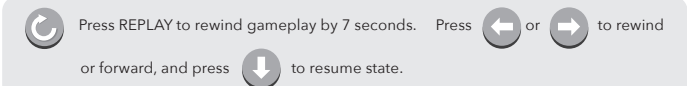

How do I save/load game state?

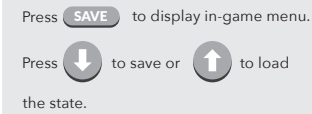

How do I go back to game menu while playing the game?

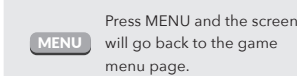

How to remove battery before disposal of product?

- Open the battery compartment cover by using screwdriver (not included).
- Push the clip in the direction indicated by arrow.
- Remove the battery before disposal of the product.

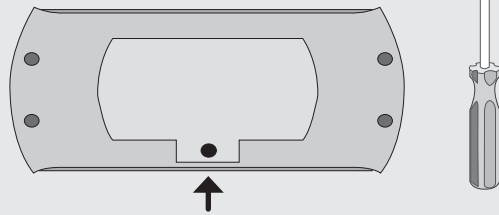

FAQ

With certain TV models, e.g., Vizio VQJ320F1A, SONY KDL-32BX310, SONY KDL-32EX308, SONY KDL-46HX729, SONY KDL-50R550A, LG 47LA6900, LG 55UB8500, Samsung UN40C7000WF and Panasonic TC-S8AX800U0, this handheld may be incompatible and cause undesired effects. These effects include display shifting, which results in the picture not being centered, and horizontal display noise, it might move up and down on the screen. If this happens, try the handheld on a different display, or return the handheld to the point of purchase.

If you have questions about this product, please visit <https://www.atgames.us/pages/faq> for possible solutions.

GAME LIST

3D Tic-Tac-Toe
Adventure
Adventure II
Amidar
Aquaventure
Asteroids®
Asteroids® Deluxe
Atari Climber
Basketball
Black Jack
Bowling
Breakout®
Centipede®
Chase It!
Circus Atari®
Crystal Castles®
Desert Falcon®
Demons to Diamonds™
DIG DUG™
Dodge 'Em
Double Dunk™

Escape It!
Fatal Run
Frog Pond
Frogger
Fun with Numbers
GALAXIAN™
Golf
Gravitar®
Gyruss
H.E.R.O.™
Hangman
Haunted House®
Human Cannonball™
Miss It!
Miniature Golf
Miss It!
Missile Command®
MotoRodeo
Night Driver™
Off the Wall

PAC-MAN™
Pitfall™
Pong® (Video Olympics)
Pooyan
Pressure Cooker™
Radar Lock™
Realsports® Baseball
Realsports® Boxing
Realsports® Football
Realsports® Tennis
Return to Haunted House
River Raid™
Saboteur®
Save Mary
Secret Quest
Shield Shifter
Slot Machine
Solaris
Space Raid
Sprintmaster
Star Ship

Stellar Track™
Strip Off
Submarine Commander®
Super Breakout®
SWORDQUEST® Earthworld
SWORDQUEST® Fireworld
SWORDQUEST® Waterworld
Tempest®
Track & Field
Tutankham
Video Checkers
Video Chess
Video Pinball
Wizard
XEVIOUS™
Yars' Return
Yars' Revenge®



SCAN
AND FIND OUT MORE
ABOUT THIS PRODUCT!

Caution

- Do not use or store the battery where it is exposed to extreme heat, such as beneath the window of a car in direct sunlight in a hot day. Otherwise, the battery may be overheated. This can reduce the battery performance and shorten its life.
- Do not place the battery under strong electric field or magnetic field. Doing so may damage the battery safety protection devices, thus bringing latent risks.
- Do not use the device if it gives off an odor, generates heat, becomes discolored or deformed, or appears abnormal in any way. If the device is in use or being charged, remove it from the charger immediately.

FCC Statement

This equipment has been tested and found to comply with the limits for a Class B digital device, pursuant to Part 15 of the FCC Rules. These limits are designed to provide reasonable protection against harmful interference in a residential installation. This equipment generates, uses and can radiate radio frequency energy and, if not installed and used in accordance with the instructions, may cause harmful interference to radio communications. However, there is no guarantee that interference will not occur in a particular installation. If this equipment does cause harmful interference to radio or television reception, which can be determined by turning the equipment off and on, the user is encouraged to try to correct the interference by one or more of the following measures:

- Reorient or relocate the receiving antenna.
- Increase the separation between the equipment and receiver.
- Connect the equipment into an outlet on a circuit different from that to which the receiver is connected.
- Consult the dealer or an experienced radio/TV technician for help.

Changes or modifications not expressly approved by the party responsible for compliance could void the user's authority to operate the equipment.

AtGames
© 2019 AtGames Interactive
www.atgames.net

PO Box 1691, El Segundo, CA 90245
All rights reserved.

© 2019 Atari Interactive, Inc.
Atari and Atari logo are trademarks owned by Atari Interactive, Inc. All individual Atari game names and logos are trademarks or registered trademarks of Atari Interactive, Inc. or its affiliates. All other trademarks are the property of their respective owners.

© 2019 Activision Publishing, Inc. ACTIVISION is a registered trademark of Activision Publishing, Inc. All other trademarks and trade names are the property of their respective owners, including in some cases Activision Publishing, Inc.



DIGDUG™&©1983 BANDAINAMCO Entertainment Inc.
GALAXIAN™&©1983 BANDAINAMCO Entertainment Inc.
PAC-MAN™&©1982 BANDAINAMCO Entertainment Inc.
XEVIOUS™&©1983 BANDAINAMCO Entertainment Inc.

©Konami Digital Entertainment



Copyright Good Deal Games, Inc.

Asteroids Deluxe Program & Audiovisual © 2005 Atari, Inc.

Space Raid for Atari VCS/2600.
Game © Copyright 2013 Oscar Toledo Gutierrez.
Box design courtesy of CollectorVision Game, Inc.

With certain TV models, e.g., Samsung PN42C450, this console may be incompatible and cause undesired effects, like display shifting, which results in the picture not being centered on the screen, or horizontal display noise, it might move up and down on the screen. If this happens, try the console on a different display or return the console to the point of purchase.

Safety Notice

- Do not submerge the handheld in water or expose it to extreme heat or to strong magnetic fields. Doing so may cause permanent damage to your game player.
- Always use a dry towel to clean the handheld and controllers.
- Transformers are suitable for indoor use only. Transformers and power supplies for toys are not intended to be used as toys, and the use of these products by children shall be under the full supervision of parents.
- Batteries are only to be charged by adults or by children at least 15 years old.

Additional Battery Safety Messages

- To prevent possible battery leakage, overheating or explosion, please pay attention to the following measures.
- Should not be put into water. Should be placed in a dry and shady environment when not used.
- Should not be used or stored near sources of heat such as fire or heater.
- When charging, please use included charger only.
- Should not be thrown into the fire or heater.
- Should not be connected as short circuit.
- Should not be struck, thrown, or stepped on.
- Should not be welded directly.
- Do not use nail or other sharp tools to pierce the battery.